

# ESTANTERÍA BAJA NORDIK

ATENCIÓN AL CLIENTE  
(+34) 966 422 117

HORARIO: 8:00h a 15:00h de lunes a viernes  
www.ohcielos.com - info@ohcielos.com

 **ohcielos.com**  
muebles y decoración



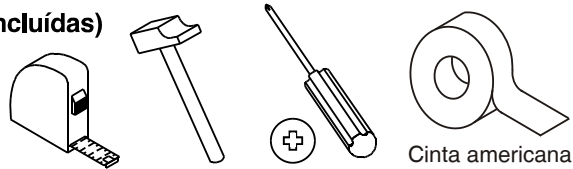



## Las herramientas que necesitas (no incluidas)



## Las piezas incluidas en el kit

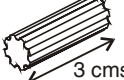
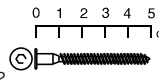
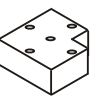
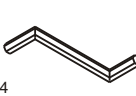
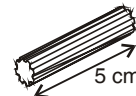
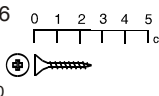

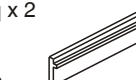
## Los herrajes que encontrarás en el kit

Col x 2 Nº721060 	Exc x 4 Nº721016/721017 	Tap x 8 Nº721308  3 cms	Aut x 4 Nº721002  0 1 2 3 4 5 cm
Pat x 4 Nº710186 	Lz x 1 Nº721034 	Tam x 2 Nº721508  5 cms	Tpt x 16 Nº721070  0 1 2 3 4 5 cm
Moldgr x 1 Nº710167 	Moldpq x 2 Nº710160 	Cesta x 2 Nº710176 	

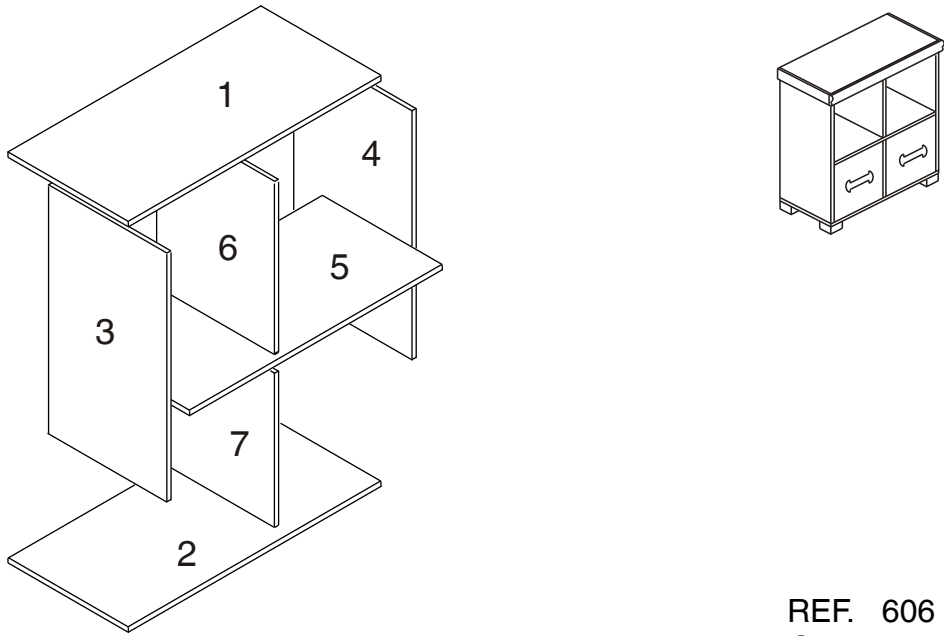
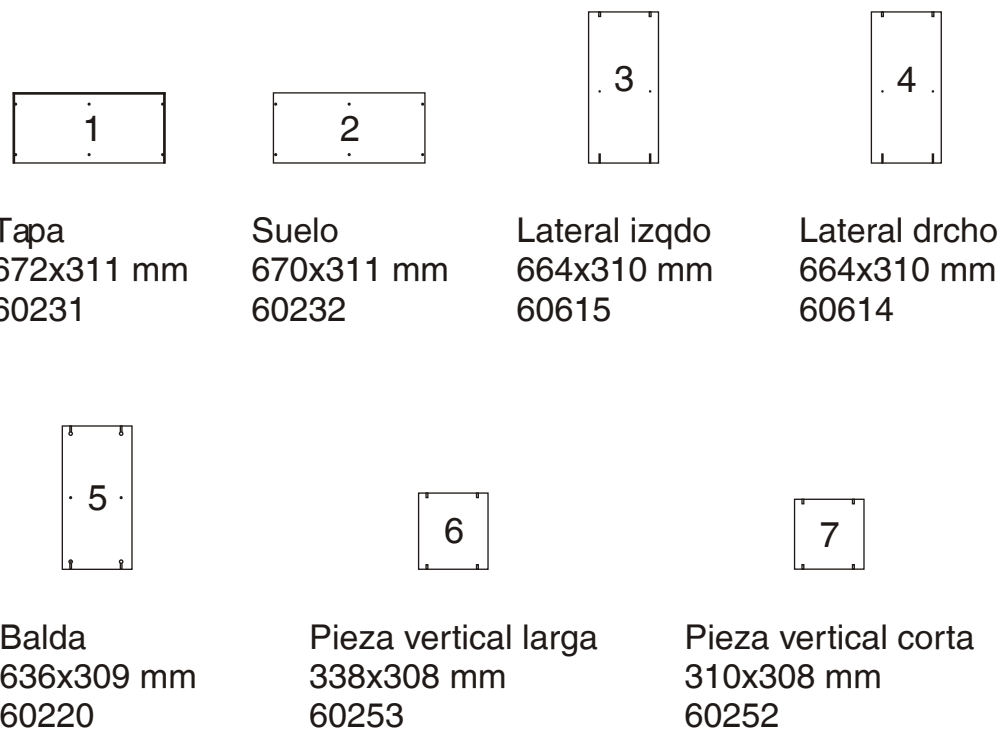

REF. 606  
LOTE 5138

## Te aconsejamos

Ordena y cuenta las piezas y herrajes





Habilita una zona para el montaje

No fuerces los tornillos y los elementos de montaje

Sigue paso a paso las instrucciones de montaje

# 1

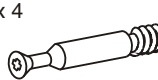
## El primer paso es el montaje de los herrajes

Col x 2 	Tap x 4  3 cms	Exc x 4 	
---	--	--	---

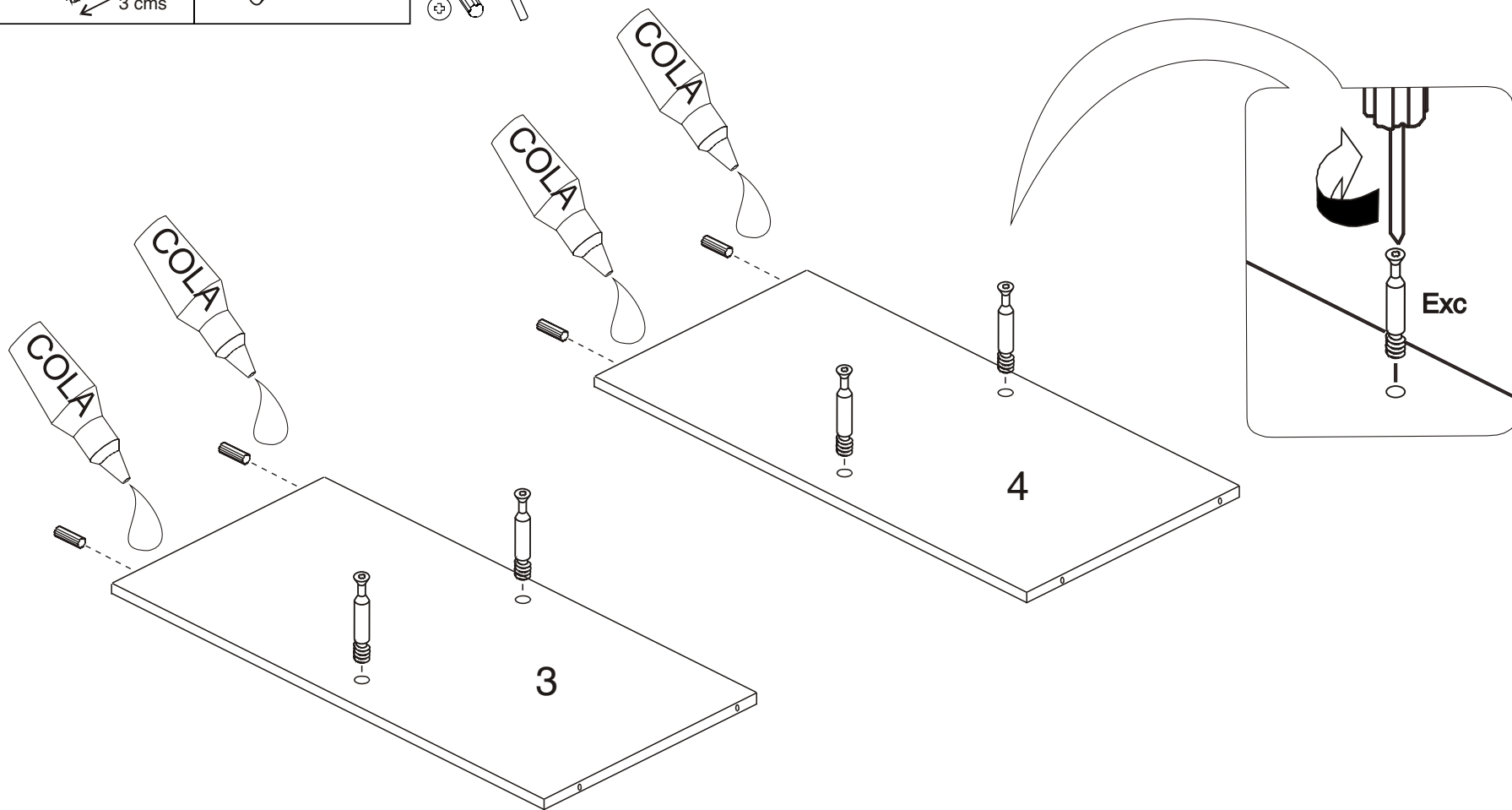

# 1

## El primer paso es el montaje de los herrajes

- Col x 2
- Tap x 4
- Tam x 2

Los mechones "Tap" se utilizan para el ensamblado tanto del techo como del suelo

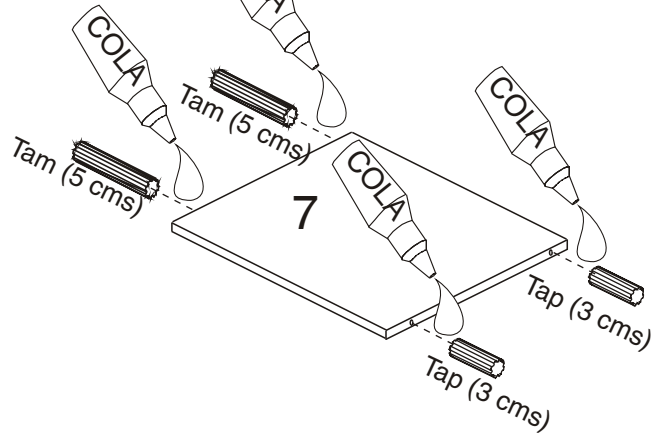
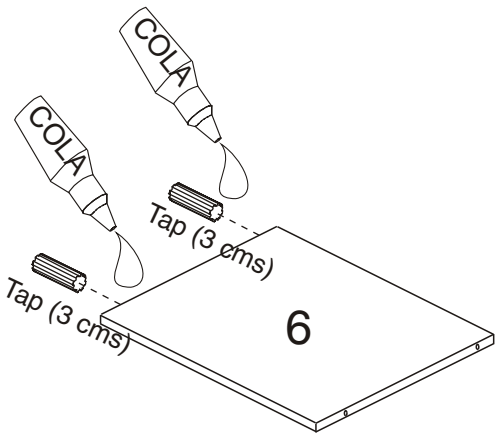

- Exc x 4

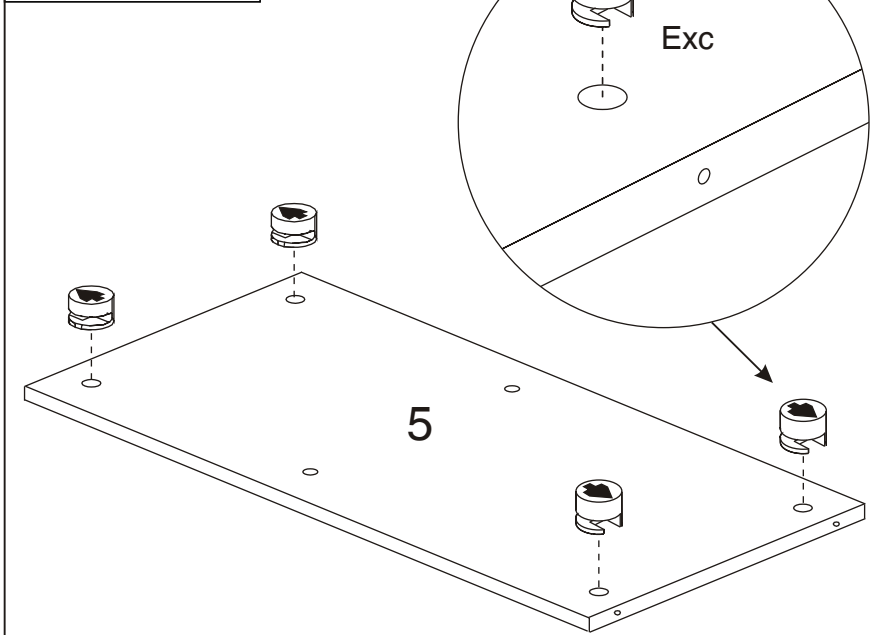

# 2

- Col x 1

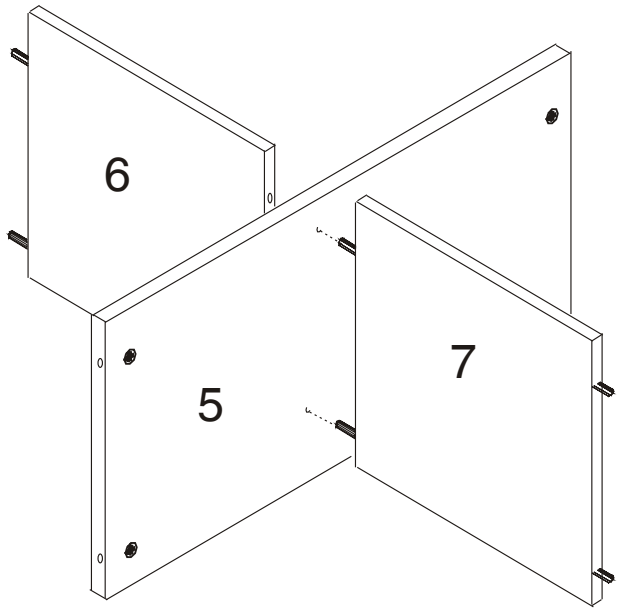

# 3

- Lz x 1

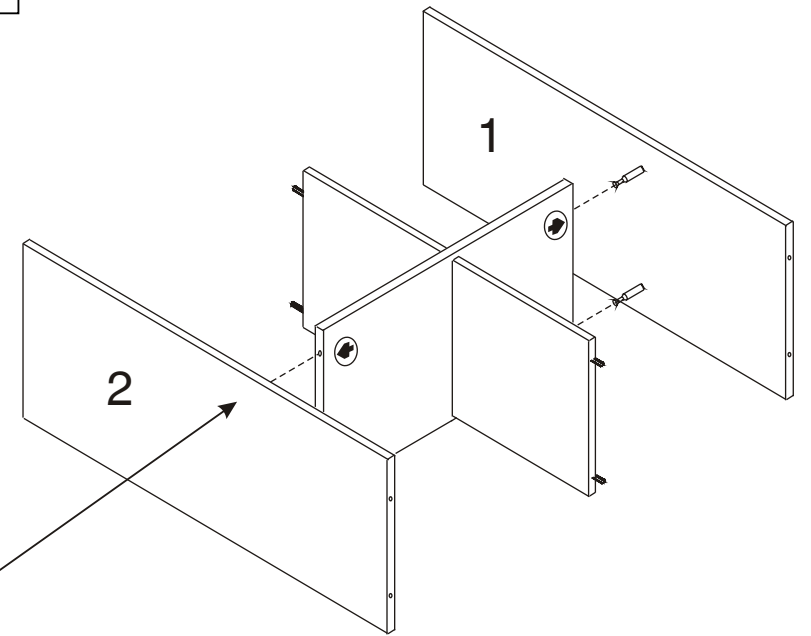
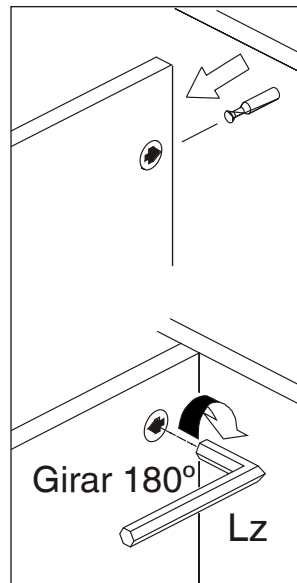

# 3

- Col x 1
- Lz x 1
- Aut x 4
- Pat x 4
- Tpt x 16

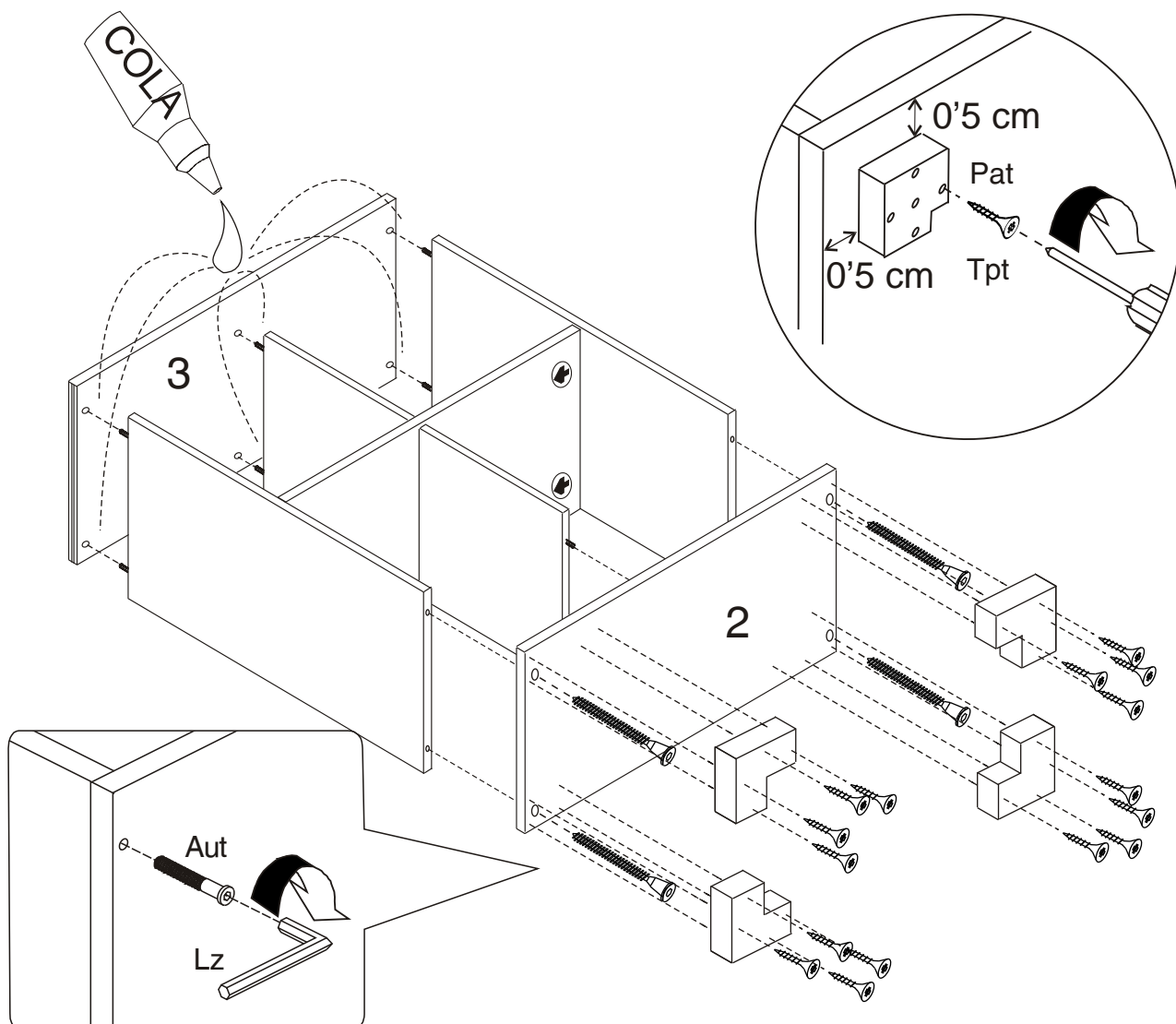

# 4

- Col x 1
- Moldgr x 1
- Moldpq x 2
- Cesta x 2
- Cinta americana

Precintar las molduras hasta que seque la cola (aprox. 3 horas)

